

Mitoitusohje eri aukeamiskulmille ja ovipainoille

Ylösaukeavalle

75°

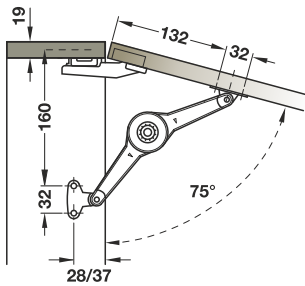

90°

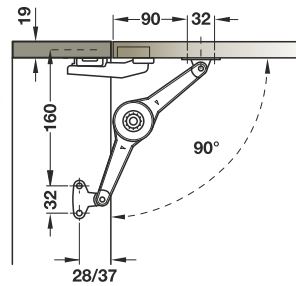

110°

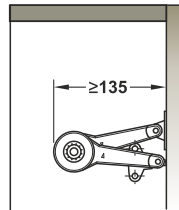
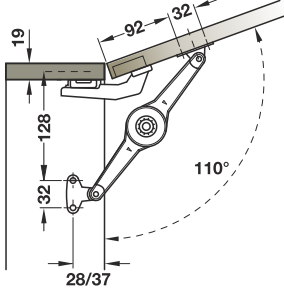

Alasaukeavalle

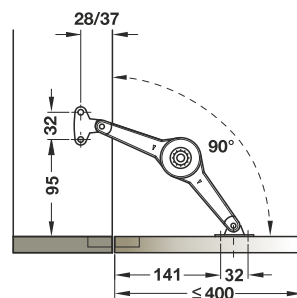
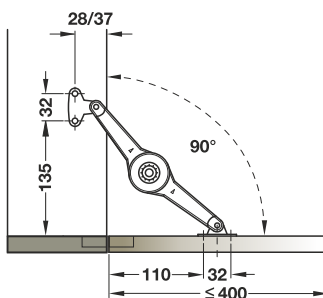

Vaatii erillisen salvan

Ilman erillistä salpaa

Käytä alasaukeavalle etulevylle aina kahta aukipitolaitetta.

	Etulevyn korkeus mm	Etulevyn paino kg				
		Lukitsemaan		Hidastamaan		
		1 kpl	2 kpl	1 kpl	2 kpl	
Ylösaukeavalle						
75°	200	9.0	15.0	11.5	15.0	
	250	7.0	15.0	9.0	15.0	
	300	6.0	12.0	7.5	15.0	
	350	5.0	10.0	6.5	13.0	
	400	4.5	9.0	6.0	11.5	
	450	4.0	8.0	5.0	10.0	
90°	500	3.5	7.0	4.5	9.0	
	200 – 400 ks. kuten alasaukeavalle					
	450	3.5	6.5	4.5	8.5	
	500	3.0	6.0	4.0	7.5	
	110°	200	6.0	12.0	8.0	15.0
		250	5.0	9.5	6.0	12.0
300		4.0	8.0	5.0	10.0	
350		3.5	7.0	4.0	9.0	
400		3.0	6.0	4.0	7.5	
450		2.5	5.5	3.5	7.0	
500	2.0	5.0	3.0	6.0		
Alasaukeavalle						
90°	200	7.5	15.0	9.5	15.0	
	250	6.0	12.0	7.5	15.0	
	300	5.0	10.0	6.0	13.0	
	350	4.0	8.5	5.5	11.0	
	400	3.5	7.0	5.0	10.0	
	450	3.0	6.0	4.0	9.0	

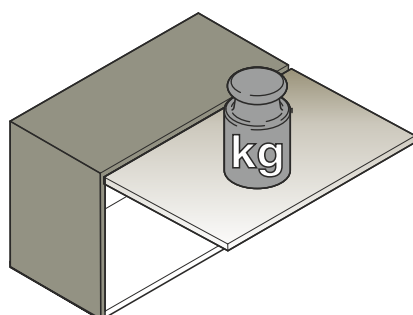
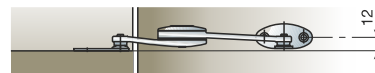

Vastuksen säätö nivelen keskeltä SW4 kuusiokoloavaimella

